

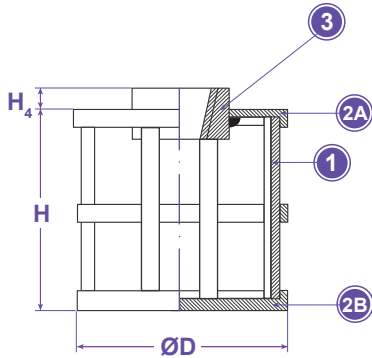

SH 1-1/2" to 4"

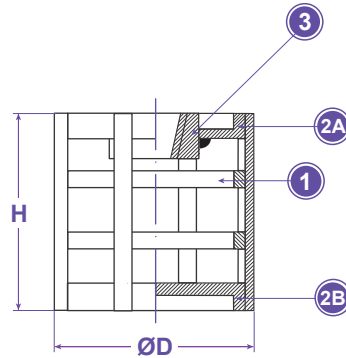

SH 6"



SH 8"

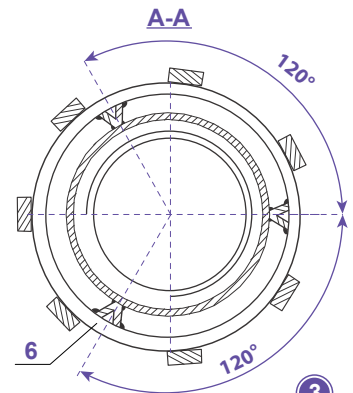

1 - Cover

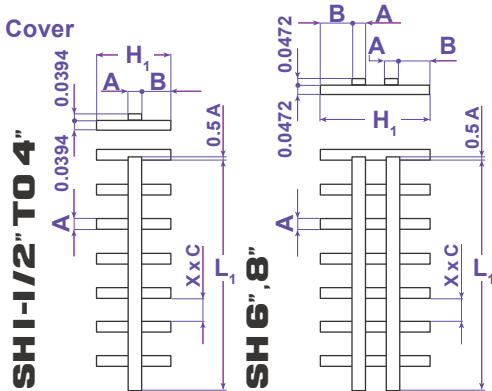

2A - Top

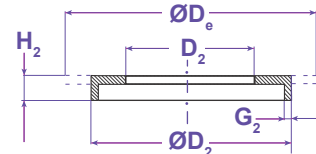

2B - Bottom

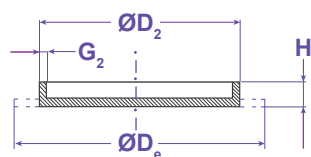

3 - Part with Thread

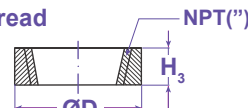

4 - Protecting

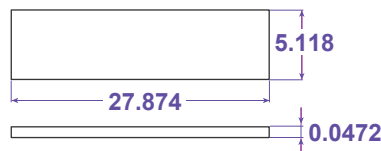

5 - Corbel

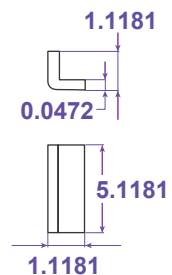

Material:

1-Covering:

1-1/2" -- > 4" Steel sheet = 0.0394
4" -- > 6" Steel sheet = 0.0472

2A - Top / 2B - Bottom:

1-1/2" -- > 4" Steel sheet = 0.0394
4" -- > 6" Steel sheet = 0.0472

3 - Part with thread:

Steel tube

4 - Protecting:

Steel sheet = 0.0472

5 - Corbel:

Steel sheet = 0.0472

Size	H	H1	H2 +/-0.1181	H3	H4	D	De	D2	D3	Di	L1	G1	G2	A	B	C	X	PART #
1-1/2" NPT	3.8583	3.7008	0.3937	0.7874	0.5118	4.7638	5.4331	4.7638	2.1260	2.1457	14.8819	0.0394	0.0394	0.5906	1.5551	1.0630	0.3543	SH20B
2" NPT	3.8583	3.7008	0.4331	0.7874	0.5118	5.9055	6.6535	5.9055	2.6575	2.6772	18.5039	0.0394	0.0394	0.5906	1.5551	1.0827	0.3937	SH25B
2-1/2" NPT	3.8583	3.7008	0.4331	0.7874	0.5118	5.9055	6.6535	5.9055	3.1496	3.1693	18.5039	0.0394	0.0394	0.5906	1.5551	1.0906	0.3937	SH30B
3" NPT	5.1181	4.9213	0.4331	0.7874	0.5118	6.8898	7.5984	6.8898	3.7402	3.7598	21.5748	0.0394	0.0394	0.7874	2.0669	1.6063	0.3150	SH35B
4" NPT	5.1181	4.9213	0.4331	0.7874	0.5118	6.8898	7.5984	6.8898	4.7638	4.7835	21.5748	0.0394	0.0394	0.7874	2.0669	1.6063	0.3150	SH40B
6" NPT	8.7402	8.7402	0.6299	0.8661	-	8.9764	9.8425	8.8583	7.0000	7.0276	27.7953	0.0472	0.0472	0.7874	1.9685	2.2992	0.3150	SH60B
8" NPT	11.4173	11.4173	0.5118	0.8661	-	11.1417	11.8110	11.0236	8.8583	8.8898	34.6063	0.0472	0.0472	1.1811	3.2677	3.7598	0.2362	SH80B

FEATURES & APPLICATIONS:

• **General Uses:**

-



TITLE STRAINERS - SQUARE HOLE

DISCLAIMER

All drawings and specifications are subject to change without notice. Drawings represent general dimensions of our products. Seal Fast cannot guarantee the dimensions in the drawing will exactly match those in the drawing. This drawing is the property of Seal Fast Inc. Copying or reproduction of this drawing is expressly prohibited.

MATERIAL

ZINC PLATED

DRAWING NOT TO SCALE

PART #

SH ..B