



SEALFAST
THE SIMPLE SOLUTION

**COUPLINGS
& ACCESSORIES**



TYPE DD

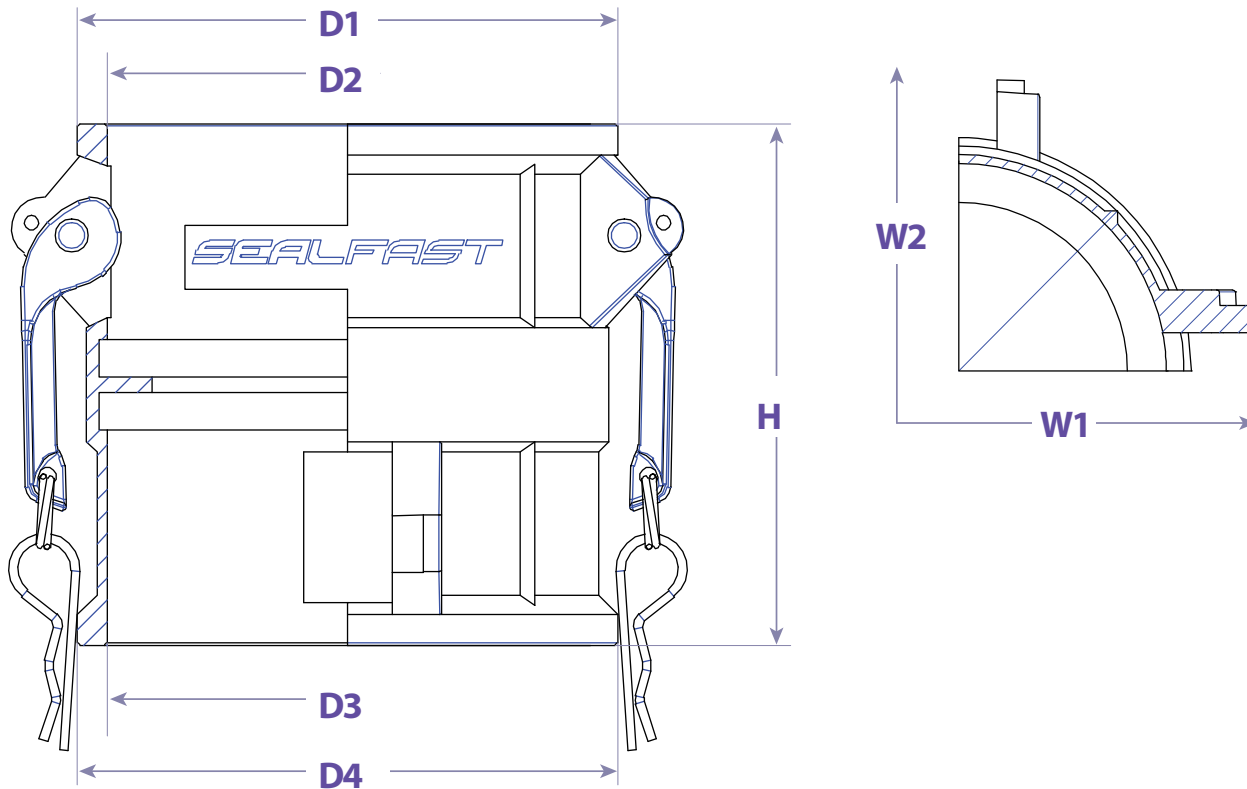

FEATURES & APPLICATIONS:

• General Uses:

A camlock fitting is a type of coupling that is used to connecting hose and or pipes together that transfers liquids, powders and granules. A straight through connection is made that maintains the pipe size and allows the free flow of materials being transferred.

Size	Working PSI	D1	D2	D3	D4	H	W1	W2	PART #
1-1/2"	150								DD150SS
2"	150	2.894	2.508	2.508	2.894	2.894	3.681	5.197	DD200SS
2-1/2"	150								DD250SS
3"	150	4.075	3.626	3.626	4.075	3.937	5.079	5.079	DD300SS
3" x 2"	150	4.075	3.626	2.508	2.890	5.709	5.106	3.504	DD3020SS
3" x 4"	150	4.075	3.626	4.732	5.197	6.299	5.262	6.389	DD3040SS
4"	150	5.197	4.732	4.732	5.197	4.094	6.181	6.181	DD400SS
4" x 6"	150	5.197	4.732	6.949	7.579	7.087	6.389	9.046	DD4060SS
5"	150	6.260	5.752	5.752	6.260	4.252	7.323	7.323	DD500SS
5" x 4"	150								DD5040SS

WARNING: Cam & Groove Couplings should **NOT** be used with any compressed gas, including steam or air. Metal fittings should **NOT** be used with Polypropylene Cam & Groove. Dust Caps and Dust Plugs are **NOT** designed for pressure applications.

Note: All Seal Fast Cam & Groove Stainless Bodies are 316 Investment with 304 Handles.

TITLE **TYPE DD - FEMALE X FEMALE SPOOL COUPLER**

DISCLAIMER

All drawings and specifications are subject to change without notice. Drawings represent general dimensions of our products. Seal Fast cannot guarantee the dimensions in the drawing will exactly match those in the drawing. This drawing is the property of Seal Fast Inc. Copying or reproduction of this drawing is expressly prohibited.

MATERIAL

SUS 316

DRAWING NOT TO SCALE

PART

DD...SS



sales@sealfast.com

800.231.0734

sealfast.com

5603 Harvey Wilson Drive, Houston, TX 77020